

WELCOME TO LATVIA!



EDI GUIDE FOR VISITORS

YOU CAN CLICK ON ALL
GREEN UNDERLINED WORDS

AIRPORT: RIGA

AIRPORT CODE: RIX

LOCATION: MAP

RECOMMENDED AIRLINE: AIRBALTIC

(70 DIRECT FLIGHTS)



**ARRIVING
IN
RIGA**





TRANSPORT
(TAXI)

FROM RIGA AIRPORT TO CITY CENTER (~€ 15)

FROM RIGA AIRPORT TO EDI (~€ 25)

FROM CITY CENTER TO EDI (~€ 15)

WE STRONGLY RECOMMEND
TO CHOOSE
BALTICTAXI (+371 20008500)

OR

REDCAB (+371 8383)

OR

BOLT APP



YOU CAN CLICK ON ALL
GREEN UNDERLINED WORDS

FROM RIGA AIRPORT TO CITY CENTER

Bus No. 22 (TIME TABLE) (€2, TICKETS FROM THE BUS DRIVER AVAILABLE)

ROUTE

FROM CITY CENTER TO EDI (BUS STOP DZARBENES IELA)

BUSES No. 1, 14, 21 (TIME TABLE) (€2, VENDING MACHINES)

TROLLEYBUS No 4, 12 (TIME TABLE) (€2, VENDING
MACHINES)

ROUTE



TRANSPORT
(PUBLIC TRANSPORT)

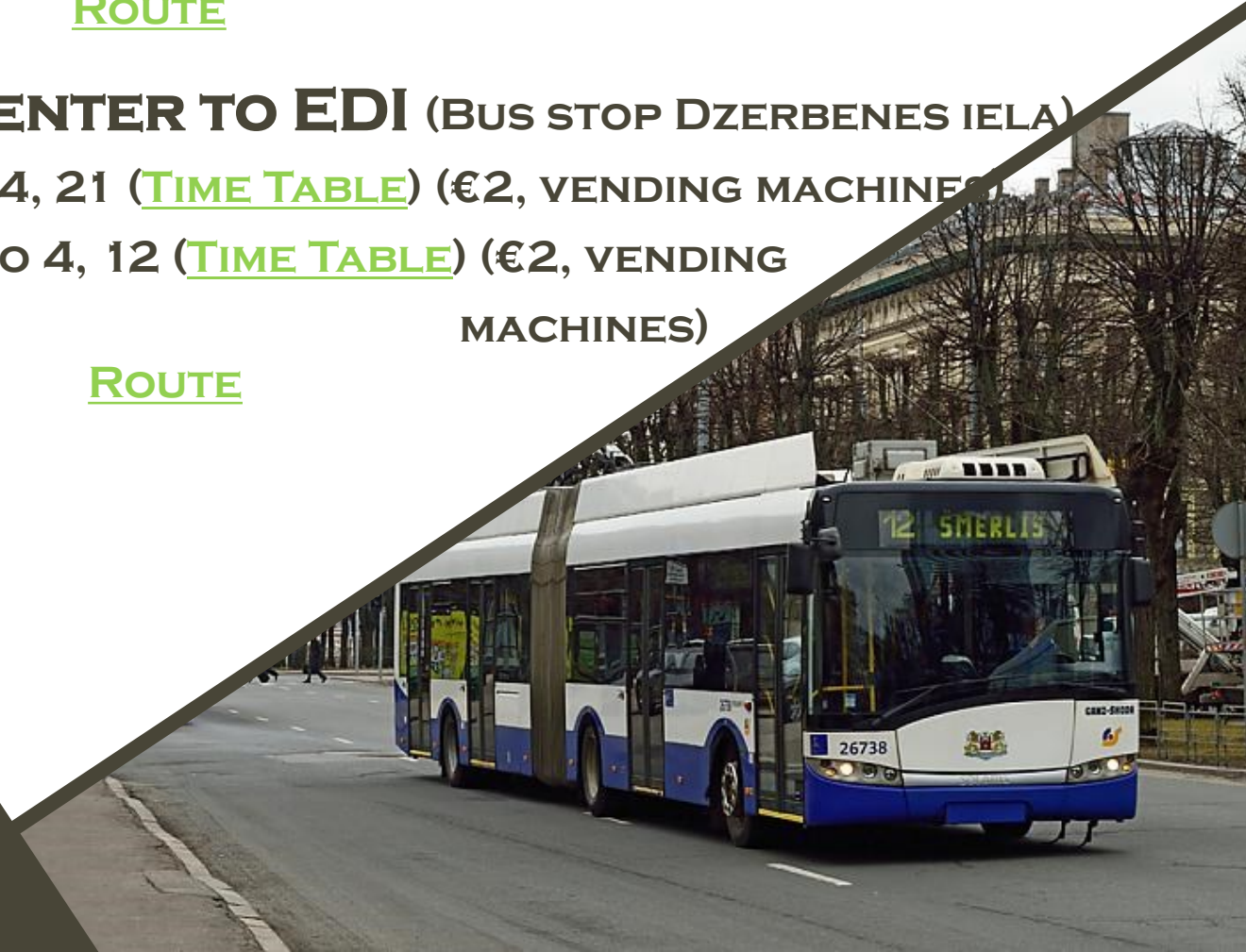

EDI (ELEKTRONIKAS UN DATORZINATNU INSTITUTS)

ADDRESS:

14 DZARBENES STREET, RIGA, LATVIA ([MAP](#))

CONTACT PERSONS:

MODRIS GREITANS

MODRIS_GREITANS@EDI.LV

+371 28398813

KASPARS OZOLS

KASPARS.OZOLS@EDI.LV

+371 25449662



**VISITING
EDI**

YOU CAN CLICK ON ALL
GREEN UNDERLINED WORDS

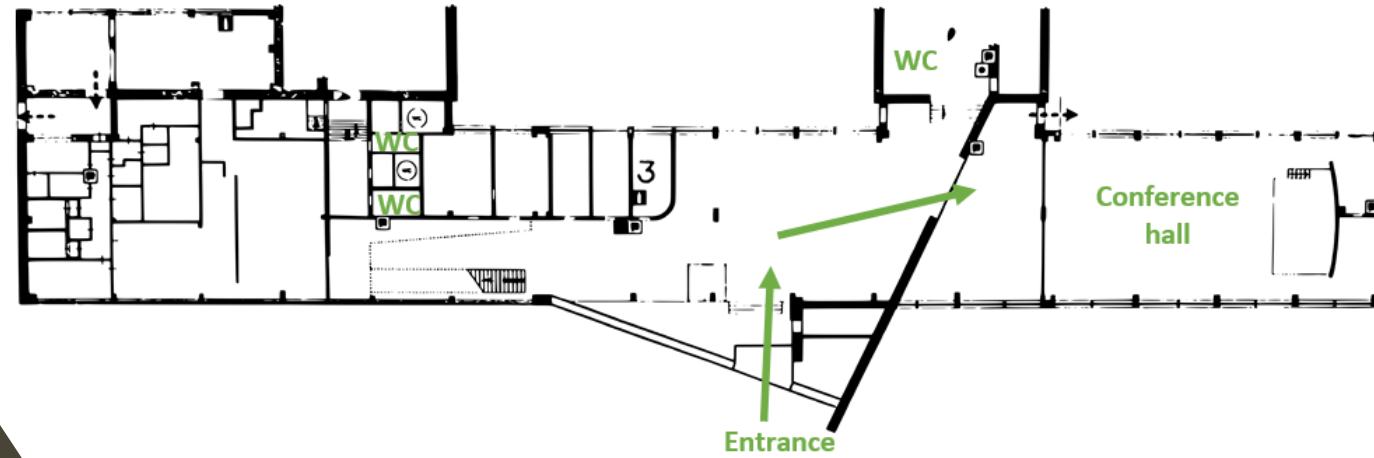

1ST FLOOR PLAN

FREE
PARKING IS
AVAILABLE
NEAR EDI



VISITING EDI